

The machine is suitable to string one rope.
The bull-wheel grooves are made of thermally treated steel

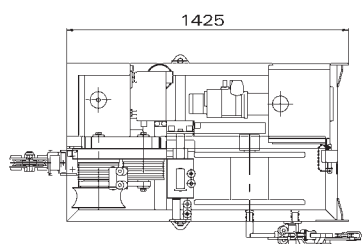

Certified Quality System
ISO 9001:2000

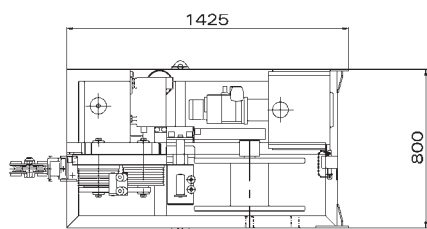
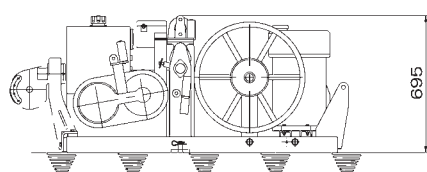

PERFORMANCE

Max pull	15 kN
Speed at max pull	0.7 km/h
Max speed	3.6 km/h
Pull at max speed	4 kN

Note: the basic machine performance is calculated at 20°C and at sea level

CHARACTERISTICS

Bull-wheel diameter	200 mm
Max rope diameter	8 mm

ENGINE

Gasoline	13 kW
Cooling system	air
Electrical system	12 V

HYDRAULIC TRANSMISSION

Closed hydraulic circuit for stepless speed variation in both rotating directions

CONFIGURATION

Negative self-acting hydraulic brake
Hydraulic dynamometer with set-point and automatic control of maximum pull

Built-in reel winder with automatic level wind and special reel for 500 m of Ø 8 mm rope

OPTIONAL

- 102 Pulling rope locking device when capstan is used (compulsory for EC market)
- 105 Rigid axle and towing bar detachable, for manual towing
- 107 Capstan (diameter=220 mm equipped with guide rope rollers)
- 111 Cable guide pivot pulley suitable for work in manhole and into ditch

M = 500 kg
(without rope)



Opt. 111