

Hydraulic winches specifically designed for stringing operations on low and medium voltage overhead lines.

The winches are available in 2 versions: with 2 side capstans (Mod. AMB 206) or with 1 side capstan and 1 drum with automatic level wind (Mod. AMB 207)

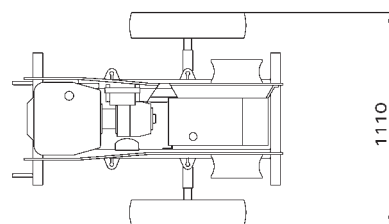

AMB 206 M = 300 kg

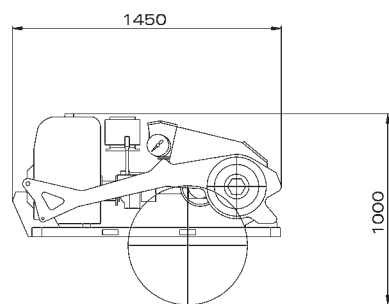
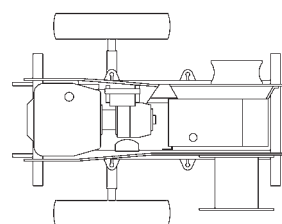

AMB 207 M = 320 kg

PERFORMANCE

Max pull	15 kN
Speed at max pull	0.35 km/h

Max speed	2.4 km/h
Pull at max speed	5 kN

Note: the basic machine performance is calculated at 20°C and at sea level

DRUM CHARACTERISTICS

External diameter	378 mm
Internal diameter	220 mm
Width	215 mm
Capacity 220 m	rope Ø 8 mm

CAPSTAN CHARACTERISTICS

Diameter	220 mm
----------	--------

ENGINE

Gasoline	8.1 kW
Cooling system	air
Starting system	rewind

HYDRAULIC TRANSMISSION

Closed hydraulic circuit for stepless speed variation in both rotating directions

CONFIGURATION

Negative self-acting hydraulic brake

OPTIONAL

- 102 Pulling rope locking device when capstan is used (compulsory for EC market)
- 105 Rigid axle and towing bar detachable, for manual towing